

# Direct wall fixation bracket HDG

Reference CSU795466

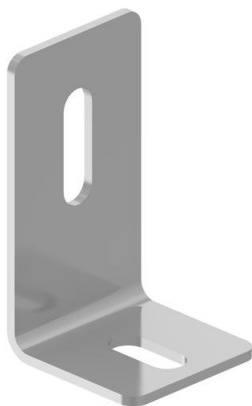

Activity	Cable support systems
Product family	Support system
Brand	Wibe

## Commercial and Web

Short description	Direct wall fixation bracket HDG
Medium description	Wibe - wall bracket H85 - steel hot-dip galvanized
Material	Steel
Material type or surface treatment	Hot-dip galvanized
Corrosion class	C4

## Base

Activity	Cable support systems
Product family	Support system
Brand	Wibe
GTIN	3606481192110

## ETIM (EC001003-Wall- and ceiling bracket for cable support system)

Suitable for cable management system width (EF008339)	* mm
Suitable for cable management system height (EF006391)	85 mm
Model (EF000010)	Other
Suitable for wire mesh tray (EF005163)	No
Suitable for cable ladder (EF005165)	Yes
Suitable for cable tray (EF005166)	No
Tray mounting (EF005212)	Screwable

Load bearing capacity (EF002918)	* kN
Suitable for circuit integrity (EF007806)	No
Material (EF002169)	Steel
Material quality (EF001257)	*
Surface protection (EF000139)	*
Colour (EF000007)	*
RAL (EF000116)	*

---

## Logistic

Pack 1 type	Each
Quantity pack 1	1
Weight pack 1	.245 kg
Length pack 1	40 mm
Width pack 1	72 mm
Height pack 1	115 mm
Customs code	73089059
Net weight	.25 kg
Country of origin	SE

---

## Certification

ETIM class	EC001003
------------	----------

---

## Status product

Product status	Commercialized
----------------	----------------

---

## Environmental

GWP Total A1-A3	.6836 kgCO2e
-----------------	--------------

---

## Product downloads

---

For the latest information check <http://wibe-group.com/cable-support-systems/cable-ladders/accessories/direct-wall-fixation-bracket-hdg>